

Brick slip lintels

B section range 365 mm high

Section at span:

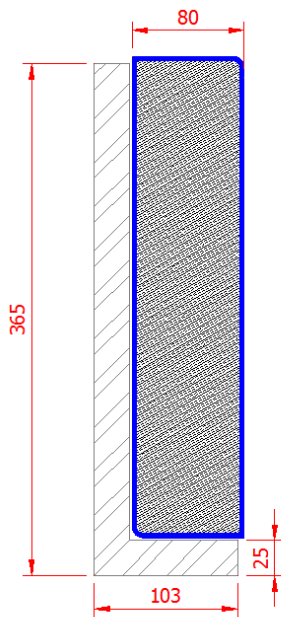

Section at bearing:

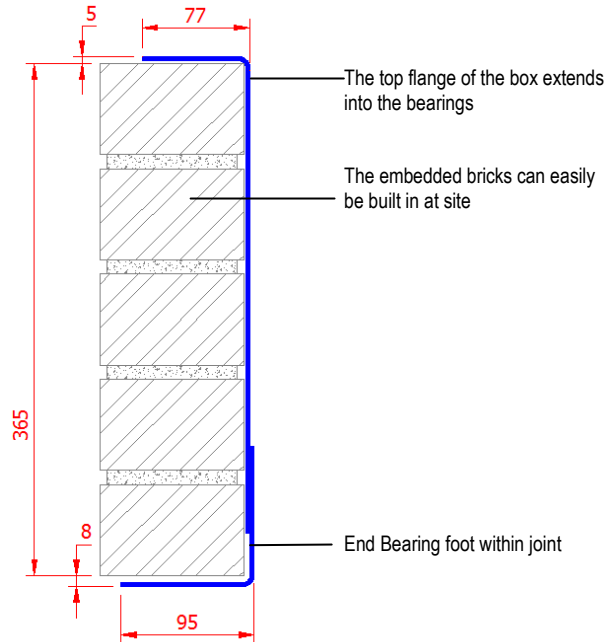

B365/3

Lintel section properties

Ixx	3251.6 cm ⁴
Zxx	189.6 cm ³
Weight	19.9 kg/m
Area	24.9 cm
Ryy	3.6 cm

B365/4

Lintel section properties

Ixx	4331.0 cm ⁴
Zxx	251.8 cm ³
Weight	26.5 kg/m
Area	33.1 cm
Ryy	3.6 cm

B365/6

Lintel section properties

Ixx	6482.7 cm ⁴
Zxx	374.7 cm ³
Weight	39.7 kg/m
Area	49.6 cm
Ryy	3.6 cm

Lintel load Capacity Table

Opening Span	Lintel Length	Safe Load kN	Load Example
600	900	146.2	
900	1200	146.2	
1200	1500	146.2	
1500	1800	146.2	
1800	2100	146.2	
2100	2400	123.5	
2400	2700	106.6	
2700	3000	93.4	
3000	3300	82.9	
3300	3600	74.3	
3600	3900	67.2	
3900	4200	61.1	
4200	4500	55.9	
4500	4800	51.4	
4800	5100	47.5	Full height masonry
5100	5400	44.0	
5400	5700	40.9	
5700	6000	38.2	1500 mm masonry
6000	6300	35.5	

Lintel load Capacity Table

Opening Span	Lintel Length	Safe Load kN	Load Example
600	900	194.2	
900	1200	194.2	
1200	1500	194.2	
1500	1800	194.2	
1800	2100	194.2	
2100	2400	164.1	
2400	2700	141.6	
2700	3000	124.1	
3000	3300	110.2	
3300	3600	98.8	
3600	3900	89.3	
3900	4200	81.2	
4200	4500	74.3	
4500	4800	68.4	
4800	5100	63.1	
5100	5400	58.5	
5400	5700	54.4	Full height masonry
5700	6000	50.8	
6000	6300	47.2	

Lintel load Capacity Table

Opening Span	Lintel Length	Safe Load kN	Load Example
600	900	289.3	
900	1200	289.3	
1200	1500	289.3	
1500	1800	289.3	
1800	2100	289.3	
2100	2400	244.5	
2400	2700	211.0	
2700	3000	185.0	
3000	3300	164.2	
3300	3600	147.2	
3600	3900	133.1	
3900	4200	121.1	
4200	4500	110.9	
4500	4800	102.0	
4800	5100	94.2	
5100	5400	87.4	
5400	5700	81.3	
5700	6000	75.8	Full height masonry
6000	6300	70.7	

The section provides a bearing on the top flange with a second bearing at the "foot". Full bricks are laid up to the gauged brick eliminating the need for slips on site. Default material stainless steel SS370 (EN 1.4003) also available in stainless steel LDX2101 (EN 1.4162). Loadings are shown above to assist you in your selection 102.5mm brickwork is 2.2 kN/m². Dimensions can be varied to suit imperial, other brick sizes and thicker slips